

Solar Blanket

IMPORTANT SAFETY RULES

Read, Understand and Follow All Instructions Carefully Before Installing and Using this Product.

⚠ WARNING

- AVOID DROWNING RISK. THIS IS NOT A SAFETY COVER.
- ASSEMBLY AND DISASSEMBLY BY ADULTS ONLY.
- REMOVE COVER COMPLETELY BEFORE ENTRY OF BATHERS-ENTRAPMENT POSSIBLE. KEEP CHILDREN AWAY.
- CHILDREN OR OBJECTS CANNOT BE SEEN UNDER COVER.
- STAY OFF COVER - WILL NOT SUPPORT WEIGHT.
- REMOVE STANDING WATER - CHILD CAN DROWN ON TOP OF COVER.
- NON-SECURED OR IMPROPERLY SECURED COVERS ARE A HAZARD.
- ALWAYS REMOVE THE SOLAR BLANKET IN WINDY CONDITIONS AS IT MAY BLOW OFF OF THE POOL.

FOLLOW THESE RULES TO AVOID ENTANGLEMENT, DROWNING, PARALYSIS OR OTHER SERIOUS INJURY.

Instruction for METAL FRAME Style pools:

Unroll the solar blanket and place on top of water surface. Remove blanket before entering the pool.

Instruction for Easy Set[®] Style pools:

The solar blanket requires that the outside edge be tucked under the inflatable ring. This will help secure the blanket as well as help trap heat in the pool. Remove blanket before entering the pool.

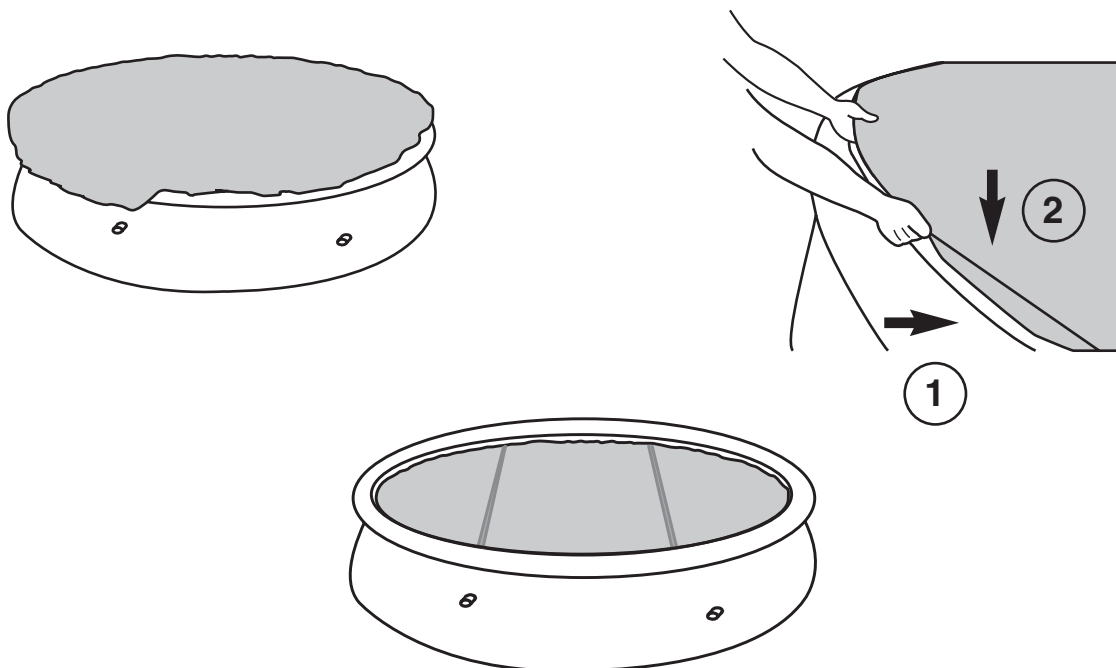

SAVE THESE INSTRUCTIONS